

# art TRAIL MANAWATŪ



*October 16 & 17*

Art studios and spaces from Pohangina  
to Foxton and everywhere in between

# art 2021

## TRAIL MANAWATŪ

### ICONS IN THIS GUIDE



**Wheelchair access**



**Toilets**



**Lift**



**Stairs**



**Coffee**



**Parking**

### Welcome to the 2021 Art Trail.

At Square Edge Community Arts, the mission statement in our recently revised strategic plan reads “connecting our city with memorable arts encounters” and this is exactly what Art Trail sets out to do. Fast becoming a major annual event in the city’s arts calendar, Art Trail brings together artists from within our community to showcase their work at various venues to the wider community.

We are grateful to our sponsors who have helped make this year’s Art Trail possible – Palmerston North City Council, Manawātū District Council, and to our partner Caccia Birch House.

Make a weekend of it – visit all the venues to see what’s on offer and enjoy the exceptional creative talent that contributes to the vast tapestry that makes up our city. You might even find that piece you’ve been looking for!

Roger Buchanan  
Board chair



[communityarts.org.nz](http://communityarts.org.nz)

**Art Trail Manawatū 2021 is the fifth to be held within our region. Through this event we celebrate the tenacity of our arts community and acknowledge the critical role that creatives in all disciplines play in upholding, inspiring, and supporting others.**

With the necessity of a second nationwide Covid lockdown, and the impact of this on the livelihoods of many artists, the importance of supporting our local Manawatū arts community is even more significant.

In 2017, the first Art Trail Manawatū was instigated. Its intention was to profile and support the diversity of creative practice being undertaken within our region, offering opportunities for artists and visitors to connect. While the original intent of this yearly event has not changed, the method that it is delivered in has had to. 2020 saw the instigation of a 'virtual' art trail which now runs alongside the physical trail, offering a very necessary alternative. Visitors can now access our website to take 'virtual studio' tours, view artists' profiles, and purchase artworks online, and (if a physical trail is possible) use this information to plan their routes.

Over 120 individuals, including artists, the Square Edge Team, our design team, and workshop tutors have been working for many months in preparation for this event. Art Trail Manawatū 2021 is our community's opportunity to acknowledge the dedication, skill, long hours, and sheer hard work required. On behalf of the artists involved in this year's trail, I am delighted to invite you into their studios and spaces.

*nga mihi mahana*

Dr Karen Seccombe

Artistic Director, Square Edge Community Arts



## COLOURS IN THIS GUIDE

-  Square Edge
-  Caccia Birch
-  Palmerston North
-  Feilding
-  Ashhurst and Pohangina
-  Foxton

# Your chance to WIN!

**Collect 6 different coloured dots – one from each region in the 2021 Art Trail – attach them to the entry form at the back of this guide and go into the draw to win a \$700 prize package!**



Prize package includes:

- A selection of artwork by Square Shop artist ÉMILIE GÉANT, including a painting 'Letting Go' valued at \$550, a Print \$119, and Notebook \$20
- A Square Edge t-shirt with artwork by TOM TURNER valued at \$50

Leave your completed entry forms in the drop box at Square Edge Arts Centre, or scan and email them to us to add to the draw: [reception@ca.org.nz](mailto:reception@ca.org.nz)



# art TRAIL MANAWATŪ

## *exhibition opening event* \*

**Friday 8<sup>th</sup> October**  
**5.30pm**  
**Square Edge**

The Art Trail Mix exhibition opening will take place at 5.30pm on Friday 8<sup>th</sup> of October (the week before the Art Trail itself). This is a showcase of works from each of the participating artists held at Square Edge Arts Centre.

The opening event will include music, dance, and a live drawing performance by well-known local artist Naga Tsutsumi. This is a great opportunity to view works in person, pick up a trail guide book/ maps and see large format videos of our artists working in their own studio spaces.

Online artist profiles and works for sale will also be live on our website from this date. The exhibition remains up from October 8<sup>th</sup> to 28<sup>th</sup>.

\* This event is subject to Covid 19 restrictions in place at the time. Please keep an eye on our Facebook pages for updates.

# Square Edge Arts Centre

47 the Square Palmerston North



Square Edge Arts Centre is the Art Trail Manawātū 2021 starting point. Pick up your trail guidebook here and visit the 'Trail Mix' exhibition, showcasing works from each of the participating artists in one place. Works are available for purchase from the Square Shop.

The 2021 'Trail Mix' showcase exhibition opens on October 8th – the Friday before the art trail weekend – and will remain open for viewing until October 28th. Well-known local artist Naga Tsutsumi will be live drawing at the opening event on from 5.30pm. All artists and supporters are welcome to attend.

## Ground Floor

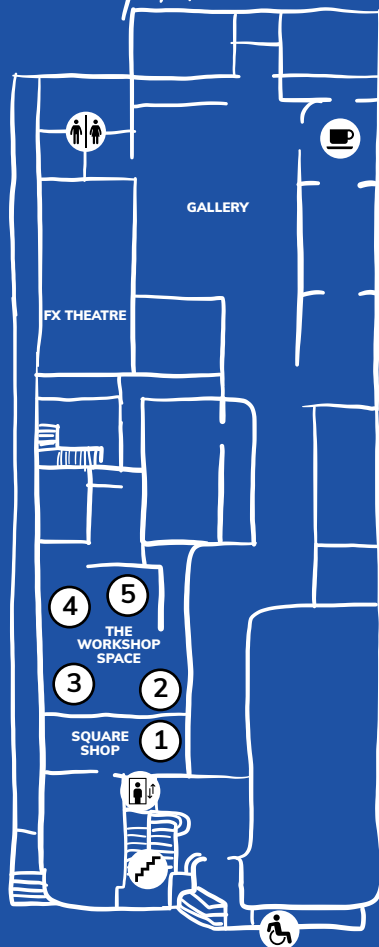

## GROUND FLOOR

### 1. The Square Shop

Square Edge office

06 241 8444

[reception@ca.org.nz](mailto:reception@ca.org.nz)

SquareShop

Stocking a range of works by 36 local artists, including pottery, paintings, drawings, cyanotype and eco prints, textiles, jewellery, and handmade books. Items are priced to suit all budgets - from a beautiful investment piece to a small gift for a friend. Our shop kaupapa or philosophy is to support, sustain and promote the work and careers of our shop artists, and to offer high quality local handmade artworks for sale.





### 2. Val Jones

021 053 0270  
val.jones@msn.com

A self-taught artist from Foxton Beach Val works in acrylic paint and inks, on canvas and board. She paints from nature - birds, flowers, trees, seascapes, and landscapes, with the paintings developing as she progresses. While she occasionally works from photographs, she always has her own take on things. Come in and see Val painting live on the day.



### 3. Shitimmaartist

021 433 111  
serenadeane29@gmail.com  
www.shit-imma-artist.com

Serena, better known as Shit-Imma-Artist, is a young artist slowly growing her audience and profile as she works to create dope street wear, upcycled items, and just all around art. She enjoys surrealism and overall trippy vibes and bases a lot of her artwork around things she likes.



### 4. Jessica Philbrick

027 399 9603  
jess.ashleymc@gmail.com  
www.j-philbrickartist.com

Jessica is a New Zealand based feminist artist. Shortly after graduating from the Elam School of Fine Arts, Jessica was nominated as a finalist for the NZ Emerging Artist Awards for her 2018 photographic series 'Performing Femininity'. She has shown work across New Zealand and in Berlin, Germany. Jessica works in oil paint and photography with the construct of femininity through appearances and domestic spaces, within a feminine colour palette. Her works offer a reflection on domestic spaces which is nostalgic and poignant.



## THE WORKSHOP SPACE

### 5. Lisa Taylor

027 696 4538  
lisataylor37@xtra.co.nz  
www.lisataylor.co.nz

Lisa Taylor has been painting for most of her adult life, turning her full attention to the arts 20 years ago. Working predominantly with acrylics, she also includes a variety of other media, and experiments with more unusual substances, to achieve a different level of feel and depth. While Lisa's style is varied, landscapes and abstract paintings make up much of her work. She believes "the key to great artwork is awareness". Lisa has won several awards and taken part in exhibitions throughout New Zealand.



## First Floor

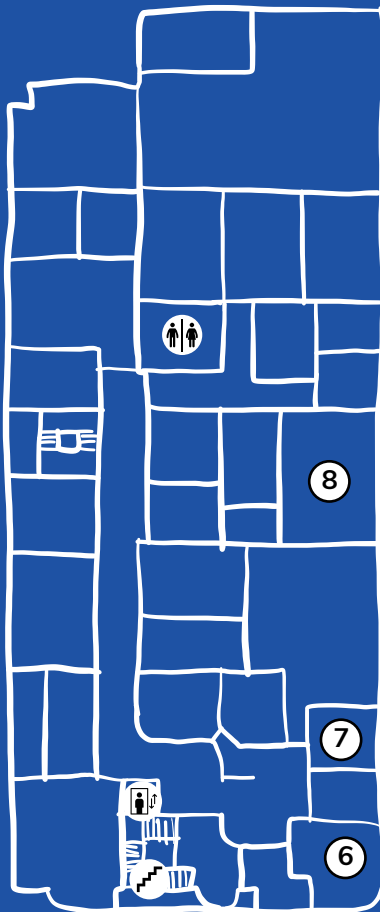

## FIRST FLOOR

### 6. Rachael Smith

Studio 102  
022 618 9644  
raheraphotography@gmail.com  
www.raheraphotography.com  
Open 10am-4pm on Saturday 16 only

Rachael is a fine art photographer and printer. She creates images of beauty in the everyday, viewing image making as an escape, a release, a means of disengaging and reengaging with the world around her. She has a master's degree in fine arts, in contemporary art, and is an Ilford Master, Sony NZ Digital Imaging Advocate, and NZIPP Master of Photography with 1 gold bar.

Rachael will be running 30-minute abstract photography classes using Intentional Camera Movement (ICM) for \$20 pp on the day. Bookings are required.





## 7. Robyn Laing

Studio 104  
021 267 8328  
Robynplaing@gmail.com

Artistic development was encouraged throughout Robyn's youth and has remained a sustaining influence, despite several years working outside the arts. In more recent years Robyn returned to study, completing a Bachelor of Visual Arts and establishing her painting studio. While she is essentially a figurative artist, her work covers a variety of themes, and she enjoys experimenting with artistic ideas, portraiture, and classical floral representation. She works in acrylics and watercolour.



## 8. Art of Framing Keith Stewart

Studio 115  
027 447 5927  
keith@artofframing.co.nz  
www.artofframing.co.nz

Keith Stewart is an internationally qualified picture framer holding the qualification of Certified Picture Framer, CPF, from the USA and Guild Commended Framer, GCF, from the UK. His studio is a framing workshop where he offers an interactive consulting & designing process for the best way to frame someone's treasured artwork. He also offers courses tailored to meet peoples' requirements to gain skills and knowledge in their area of interest about various aspects of picture framing.



## Second Floor

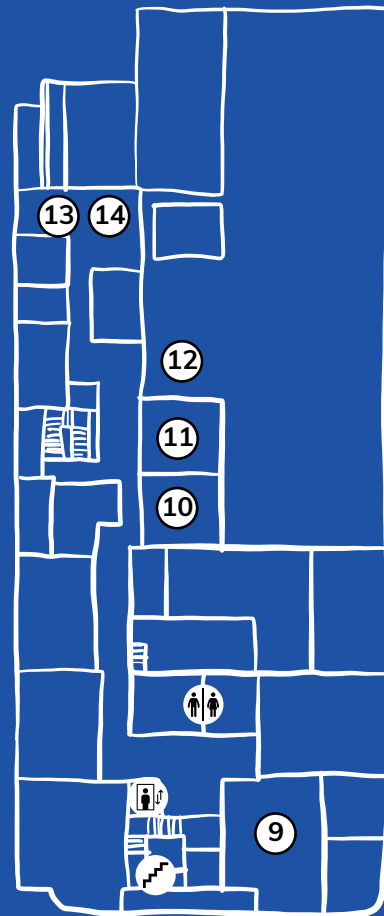

### 9. Michele Theobald

Studio 201  
027 507 1877  
theos25@xtra.co.nz  
f Michele-Theobald-Artist  
@micheletheobaldartist

Coming from a very creative family, Michele Theobald discovered an early passion for painting. She is inspired by nature, works in paint and mixed media, and enjoys creating original compositions that capture expression, movement, and the mood of the New Zealand landscape.



### 10. Cheleigh Dunkerton Artist and Creative Arts Therapist

Studio 203  
022 370 1602  
cheleigh-anne@hotmail.com  
@cheleigh\_anne

An artist and registered arts therapist Cheleigh's art is inspired by her connection with the natural environment and the human experience. Painting, stitching fabric, or making a mandala with fallen leaves- a sense of playfulness lies at the heart of her work. Cheleigh is also passionate about supporting people to access their innate creativity and improve their wellbeing. Come along, have a free play with materials, and find out what arts therapy is. Paintings, prints, drawings, and sculptures will be available for purchase.



### 11. Ken Thomas

Studio 205  
027 229 7205  
ken.thomastheartist@gmail.com

Ken is a heritage artist working in oil, pen, and ink. His work seeks to enable us to journey back into the past - as a participant and not simply a spectator. Aircraft often appear in his works. Ken is a visual storyteller currently working on several studies of the famed Spitfire.



## 12. Colin Hoare

Studio 206  
0274516627  
displico.signs@inspire.net.nz  
@ #colin-hoare-art

Colin Hoare is a well-known self-taught impressionist artist from the Manawatū. Known for his realistic portrait paintings and pen and watercolour wash drawings, Colin's most recent success was being selected into the finals for the Adam Portraiture awards for his 'Brothers' piece.



## 13. Locke Pikah

Studio 207b  
lockepickah@gmail.com

Locke Pikah is a multidisciplinary artist who is a fourth year student at Massey University studying Māori Visual Arts. Inspired by protests and activism, Locke currently resides at Marukaikuru (Shelly Bay) where they craft art from found objects.



## 14. Daphne Simons

Studio 207b  
027 380 0279  
daphnejasminesimons@gmail.com  
www.daphnesimons.com

Daphne Simons is a multi-disciplinary artist who works with drawing, printmaking, sculpture, film-making, and performance. Their work is mostly collaborative and uses humour and absurdity to research areas such as; cinematic production conventions, the lineages of Ridiculous camp theatre, non-human character construction and queer speculative writing processes.



# Caccia Birch House

130 Te Awe Awe Street  
Palmerston North



A Category 1 Historic Places Trust listing, Caccia Birch house is set in three acres of gardens with protected trees and views over the Hokowhitu lagoon.

Several artists will be housed in this beautiful venue – both inside and around the gardens. Bring a picnic, buy a coffee from Ebony Coffee on the ground floor, stop at one of our food trucks, and spend a few hours enjoying a wide range of works and a chance to meet the makers.

# Grounds & Coachhouse

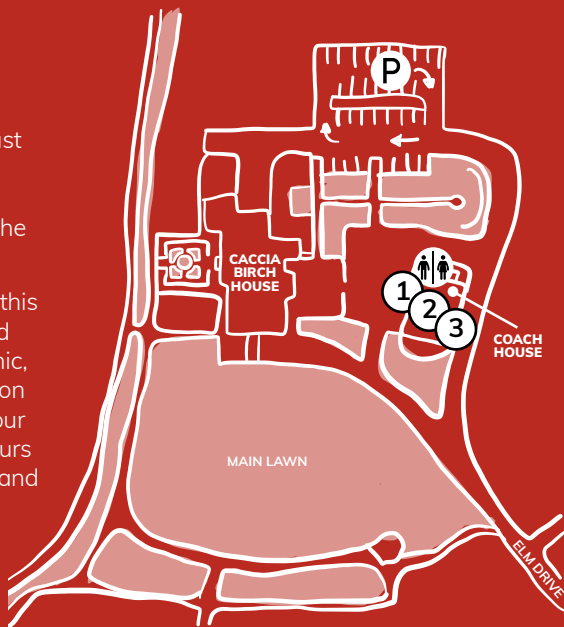

## IN THE GROUNDS

### Kimbolton Arts and Sculpture Trust

[www.ruralart.nz](http://www.ruralart.nz)

Kimbolton Sculpture Festival

kimsculpture

The Kimbolton Sculpture Festival organisers will once again have a number of sculptures on display at the PN Community Arts Trail. The sculptors displaying sculptures at the Arts Trail are Roger Thompson and Tony Waugh.

Next year's festival will be held on Saturday April 2nd 2022 and promises to be better than ever.

The organisers are hard at work preparing another program of activities and entertainment for the next festival.





## IN THE COACHHOUSE

---

Pottery, sculpture, and live burning

### 1. Michael Angelo

027 672 6435 (text only)

 MichaelAngelo

Carving is part of Michael Angelo's Ngāti Wharekōkōwai, Ngāti Kahungunu and Tūhoe whakapapa. Although he had never tried carving before, an invitation from Tony Kāpua at Papaïouru Marae in 1999 demonstrated his natural ability and led to 6 months further training with Tūhoe Tuata at Mihiroa Marae. His carving style is unique, unplanned, and comes from his soul, guided by the spiritual aspects of nature.



### 2. Ngaire from Burnt Offerings

027 829 8356

[burntofferings2013@xtra.co.nz](mailto:burntofferings2013@xtra.co.nz)

 burntofferingsnz

@ burntofferingsnz

Ngaire is an artist who specialises in upcycling second hand finds by etching mirror and stone and burning onto wood to create one-off unique pieces of art. Ngaire will be 'live burning' over the arts trail weekend – come along and watch this fascinating process.



### 3. Suzanne McAllen Pottery

021 163 9396

[suz@inspire.net.nz](mailto:suz@inspire.net.nz)

[www.suzannemcallen.co.nz](http://www.suzannemcallen.co.nz)

With a passion for individual and rustic tableware potter Suzanne McAllen believes that function, creativity, and a good aesthetic are important. Suzanne trained with Mirek Smisek (OBE) in Te Horo for about 5 years. Her works include old-school, functional, farmhouse kitchen pieces that translate from oven to table. Her works have vitality and warmth with a modern touch. Suzanne is also starting to sculpt and create outdoor garden works.



# Ground Floor

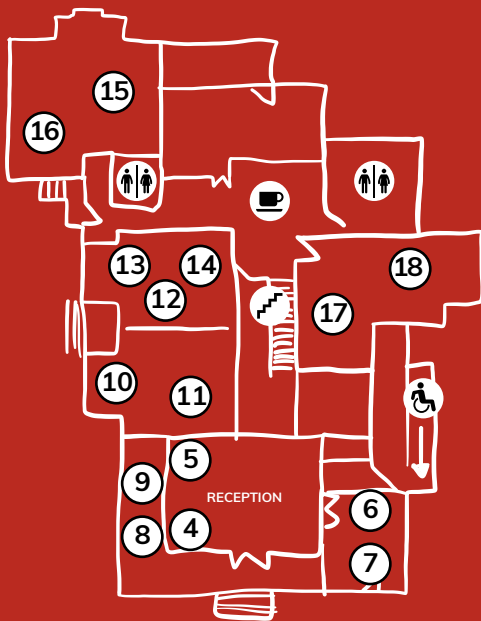

## GROUND FLOOR

### 4. FJS-art (Fabienne Joni Sopacua)

022 426 2017

fjsopacua@gmail.com

www.fjs-art.com

FJSart fjs\_art

By paying attention to details and especially to the eyes Fabienne is trying to capture the soul of every human or animal that she draws. Fabienne tries to capture the soul of every living creature she draws or paints. This years collection of works is entitled "Endangered" and is aimed to bring awareness of the beauty our planet offers, the fragility of this, and our responsibility for ensuring we don't lose it. "Unless someone like you cares a whole awful lot, nothing is going to change, it's not" (the Lorax, Dr Seuss).



### 5. Adele DuBarry

adeledubarry@gmail.com

adeledubarryartist

I was part of the 2020 Whanganui Open Studio. It was the first time I had participated, and it was with some trepidation I opened the studio doors to visitors. It was a great success for many reasons - good conversations about all things arty, praise for my work and plenty of pieces went off to new homes. It is an intense weekend, but well worth it.

*Whanganui Guest Artist -  
PNCC Artist Exchange Pilot*



## 6. David Traub

021 113 7970  
david.traub5@gmail.com  
@david.traub5  
www.glass-newzealand.co.nz

David Traub started making glass in 1972. He works in blown, fused and slumped glass from his studio in Wanganui. His work spans a range from domestic to sculptural objects and is inspired by many things, including paintings and textiles. David has been the recipient of the prestigious Cavalier New Zealand Artists in Glass award, and his work is held in numerous public and private collections across the world. David will be building a platter over the trail weekend.

Whanganui Guest Artist -  
PNCC Artist Exchange Pilot



## 7. Marcus Ingley

021 368 289  
marcus.ingley@gmail.com

Marcus discovered glassblowing at the age of 50. He fell in love with hot glass as means of expressing colour and form, with some pieces also incorporating bronze. He has a strong affinity for natural and geometric forms. He allows the glass to come to together as it will without forcing a particular shape, embedding tessellating patterns on the surface of cylindrical bodies, and exploring working with cast lead Crystal glass. Lacking the urgency of glassblowing, casting offers Marcus the opportunity to use his background as a mechanical engineer to design and refine repeatable forms.



## 8. Darren Wallace (aka Grumpy Darren)

021 995 149  
darrenwallaceart@gmail.com  
www.darrenwallace.art  
Open Saturday only

Primarily a portrait painter of people and pets, Darren undertakes land and cityscapes – which will also often have people in them. A professional artist since 2020 Darren works on commission-based work, more recently adding re-prints to his repertoire. His alter-ego “Grumpy Darren” was a radio broadcaster of 33 years. Grumpy Darren is the “Fun Artist” who loves cartooning, illustrations, pop culture art, and passing on his art skills.



### 9. Belinda Paton

022 072 5517

opalskydancer@yahoo.co.nz

www.belindapatoncreations.co.nz

www.fjs-art.com

  Belinda Paton Creations

Belinda has been a full-time artist since she graduated from art school in New Zealand in 1992. She has exhibited extensively throughout New Zealand and Australia has won many awards for her work. Clay is her number one medium – she loves the freedom of form it offers for her whimsical enchanted creations, but she also loves the vibrancy and translucency paint offers her. Inspired by the spirituality of ancestors, myths, legends, and symbols Belinda enjoys nature and creating quirky unique works.



### 10. Sandra Douglas

027 259 2268

thedougys@xtra.co.nz

@sandradowgy

Sandra has been an artist since the first moment her fingers wrapped around a crayon. Art has been her 'happy place' ever since. With a Bachelor of Applied Visual Imaging (majoring in Animation) Sandra loves the focus and repetition involved in finely detailed graphite work - the monotone allows her to explore the power of the composition and space around the subject. Four years ago, she took part in 'The Sketchbook Project' - curated by The Brooklyn Art Library - where she became hooked on creating slightly surreal ink drawings with swirling, complex lines, hand-drawn details, and gold embellishments.



### 11. Michele Edmondson

027 524 7453

whalepainter@gmail.com

A self-taught artist who loves nothing better than to be surrounded by paint and all things creative, Michelle works in acrylics, mixed media, and gouache. When she creates, she wants to tell a story, to elicit conversation, and to have the viewer engage with her work on their level. For Michelle it is about who she is as an artist. Her art is a journey and her voice.

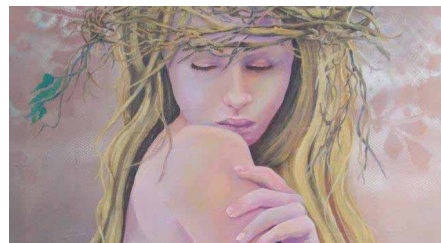



## 12. Ro Clarke

06 356 8350  
raclarke@xtra.co.nz

Rosemary enjoys painting subjects that appeal to her at the time, so her work is quite eclectic. Many ways illustrative in style her acrylic works has a whimsical and nostalgic flavour. She aims to impart a sense of fun and make people smile.



## 13. Judith Balchin

06 357 4405  
judestextileart@gmail.com  
Judes Textile Art

Judith Balchin is inspired by our native land. Known for creating miniature scenes of New Zealand using textiles, threads, acrylic paint and paper, she enhances her work with machine and hand embroidery. In 2019 she also developed an interest in using botanical plant and gelli printing.



## 14. Jin Hou

021 185 5808  
jinangle@hotmail.com  
www.jinhouartist.com

Born in Beijing China, Jin Hou came to New Zealand in 2002. She is a watercolour painter who has a Bachelor's in Mass Media from the University of Canterbury. Jin takes inspiration from travel and meditation. For her painting allows her to express herself and communicate with others. When she is painting, she puts her thoughts energy, emotions and feeling into what she does. Jin's endeavour is to construct paintings that can trigger memory and emotion, bringing viewers love, peace and light.



## GROUND FLOOR

### 15. Ali Hale Tilley

+64 632 74108

iconic.artspace@gmail.com

www.sadhanayoganz.com

Working in acrylics, gouache, and oils, Ali Hale Tilley paints vivid images that explore narrative themes of how perception, politics, and spirituality interrelate. She is the artist in residence at Iconic Art Space in Marton.



### 16. Gill Allen

021 155 5340

gillsartspot@gmail.com

www.gillallen.co.nz

Working in soft pastel and charcoal Gill will be demonstrating her process over the art trail weekend.



### 17. MS Central Districts Art Group

357 3188

mmss@inspire.net.nz

Artists Therese Cox, Jude Spanhake, Helen Sutherland, Maree Mander, Jenny Eaton, Gail Gough, Shayne Ball, and Peri Leader form the MS Central Districts Art Group. Working in watercolour and acrylic paint the MS Art Group has been operating for the past 14 years in Palmerston North. The group meets once a week and annually exhibits their mixed media work.



## First Floor

### 18. Rom Rudzki

021 783 954  
rom@export.ac.nz  
www.prealism.com

Working in acrylic ink and paint, Rom is the Founder of two art movements: Farbism and Prealism. Prealism liberates the artist from their own ego through a process of kenosis (emptying of the self) allowing pictures to emerge from their own inherent potential. Rom is also an author of art books including 'Secrets of the Artists' (available from the Square Edge shop) and is a Member of the New Zealand Society of Authors.

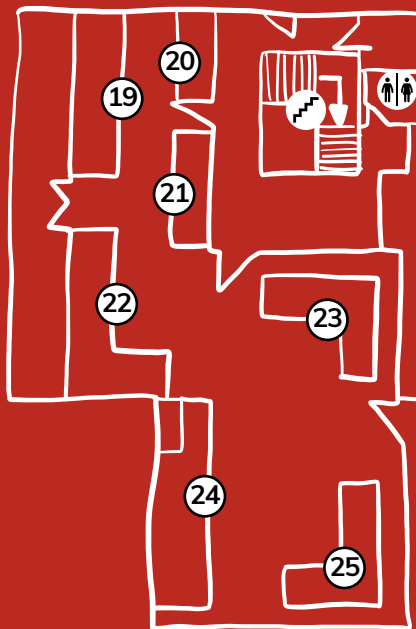

## FIRST FLOOR

### 19. Paul Lyons

06 358 7688  
palmiepaul@gmail.com  
www.paintings.nz

Having shown precisely zero talent at art in his youth, Paul unaccountably started painting watercolours at the age of forty.

In recent years, he has had several solo exhibitions, been exhibited at the New Zealand Academy of Fine Art, been Guest Artist at the Art Expo in Palmerston North. About a year ago he adopted a minimalist approach, ditching all his expensive paintbrushes and scores of tubes of paint. Now, with an old credit card, he paints watercolours with a maximum of four colours, and they have developed a greater vibrancy and presence than ever before.



### 20. Scott Oliver

021 153 3185  
karmacruz1980@gmail.com

Scott Oliver has drawn most of his life. He started painting after lockdown last year and is loving the process. As an artist he feels he is still finding himself, working most recently with the beautiful fluidity of pour works.



### 21. Susan Jestin

021 160 5642  
jestintime@xtra.co.nz

For most of her life on and off Susan Jestin has had a love for painting and drawing. Over the last 2 1/2 years she has developed an obsession for painting rocks/ stones as she feels the stones have their own story to tell. Showing the beauty of nature through their shape and texture, and becoming shop fronts, people's pets, and buildings. Her works can be used as garden or indoor ornaments, paper weights, bookends or door stops.



### 22. Jacinda Setiawan

021 023 46155  
jacinda.setiawan@gmail.com  
@jacindasetiawan

Using acrylic ink, acrylic, alcohol ink, watercolour, charcoal, gold foil Jacinda's focus is on the pursuit of beauty, grace, & wonder through high flow alchemic processing.





### 23. Keely Eastwood & Bradley Mosen

021 202 3224

keeley\_eastwood@hotmail.com

 KeeleyEastwoodArtistPrintmaker

Keeley Eastwood describes herself as a Yorkshire-born / New Zealand-based emerging artist / printmaker who enjoys playing with the myriad forms of printmaking. She has recently come to love the results that can be achieved through creating handmade 'drypoint' prints and then hand-colouring them. From an early age, following in his maternal grandfather's footsteps, Bradley Mosen has had a love of photography. His inspirations include nature and the natural landscape.



### 24. Rachel Stockley

027 339 0131

paulstockleynz@hotmail.com

Calling herself an 'Art Gypsy' Rachel is a continual student of art.

Who wanders between Printmaking, Painting, Jewellery, Sculpture, Kiln Formed Glass, Bronze and Altered books. Jewellery is her outlet to deconstruct and reuse materials that would otherwise be discarded.

Currently she is focusing on improving her painting and printmaking.

Her greatest pleasure comes from learning and enjoying shared experiences with other artists.



### 25. Val Kenwood Harrison

06 355 0509

shandchina@xtra.co.nz

A painter and tutor of porcelain for many years Val Kenward-Harrison recently decided to try oils- which she is loving. Lockdown 2020 saw her exploring watercolour, but she feels more comfortable working with the nature of oil paint. Her favourite subject matter includes flowers, and animals – particularly cows and sheep.



Palmerston North  
City



## 1. Dr Laurence Gatehouse

6 Kent Crescent  
06 3565805  
redcrocodile.nz@gmail.com

Laurence Gatehouse is a handweaver of rugs, using traditional materials and techniques. His designs involve either small repetitive patterns or larger scale compositions more suited to distance viewing. Laurence develops his designs himself and prefers to produce functional pieces. He prefers strong colours and earth tones and enjoys dying his own materials. His designs centre around his training as a scientist – representing these at both a visual and conceptual level. Laurence will have his big loom set up and will demonstrate the weaving process.



## 2. Serena Mercer

21 Ridgeview Road, Aokautere  
027 406 8156  
30glassart@gmail.com

A self-taught glass artist, Serena works in fused and flame-worked glass from her home studio in Aokautere. She also teaches classes in fusing, Serena will be demonstrating basic glass cutting techniques over the trail weekend. Come along and have a go free of charge.







## 3. Anne Morris

863 Milson Line   
027 240 2904  
annemorris@xtra.co.nz  
annemorrisart.co.nz  
Open Saturday only

Anne Morris is a painter of landscapes and portraits. Her current collection “land of the forests, swamps and lagoons” explores where we have come from, and how we have shaped our country, our land and our dwellings.



#### 4. Froyle Davies

Palmy 31 – 31 Ngata Street    
022 322 8711  
froyle@froyleart.com  
www.froyleart.com  
  Froyleart

Creating beautiful, vibrant paintings Froyle's work sparks an energy that speaks courage directly to the soul. Finding her way home to her place of origin and understanding where she belongs has revealed a sense of identity and value for Froyle. An artist for over 25 years her paintings capture the moments and expressions that celebrate life. Varying in scale every original piece offers the opportunity to experience the love, hope and sense of freedom infused by the artist.





#### 5. Vonnie Sterritt

The Art Studio     
791 Main Street  
027 246 8043  
vonniesterritt@gmail.com  
www.artsterritt.com

A landscape artist for the most part, Vonnie has a liking for the parochial, and a love of colour, atmosphere and light. Vonnie will be painting over the weekend – pop in and chat to her as she works.



#### 6. Te Whatu Raranga O Highbury Weavers

Highbury Shopping Centre    
119 Highbury Ave  
021 209 2803  
highburyweavers@outlook.com  
 Highburyweavers

Te Whatu O Raranga O Highbury Weavers are a group of weavers using traditional Maori weaving skills in both traditional and contemporary materials. The group's aim is to uphold the mana and tikanga of traditional Maori weaving and to participate in, and promote, activities that involve and enhance the wider community. It was the foresight and love of weaving that the late Yvonne Marshall QSM brought to the founding of Te Whatu O Highbury Weavers, and the group has thrived since this time, creating, and inspiring many fine weavers.





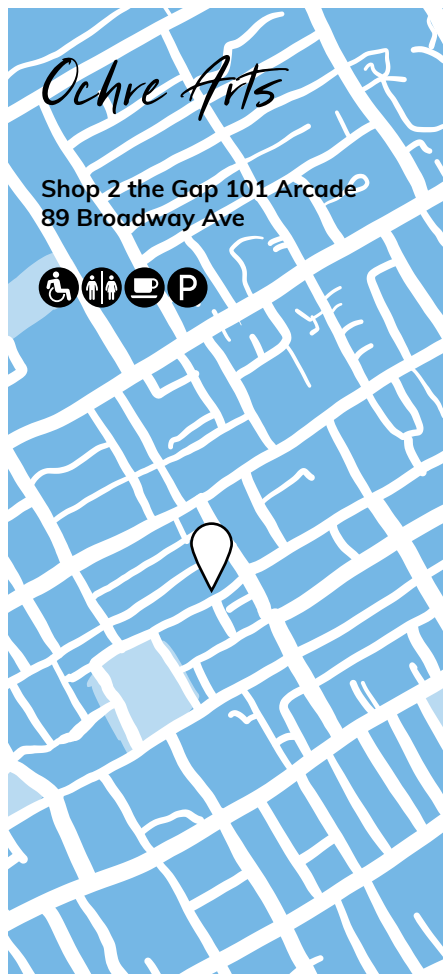

## 1. Suzi Brown Glass

027 314 3607

[suzi@suzibrownglass.co.nz](mailto:suzi@suzibrownglass.co.nz)

[suzibrownglass.co.nz](http://suzibrownglass.co.nz)

Glass artist Suzi Brown provides restoration, design and build services in stained glass, using both lead and copper foil methods. Between making windows she designs and creates unique handcrafted glass art for giftware and décor. Suzi also hosts workshops. Her studio shop stocks a groovy selection of new and reclaimed glass, tooling and materials for your own glass art needs. This is a great place for leadlighters and mosaic artists to find treasures.



## 2. Thistleburn Pottery Carla Woollaston

027 283 7662

[carla@fluffymilk.com](mailto:carla@fluffymilk.com)

[fluffymilk.com](http://fluffymilk.com)

Carla Woollaston is a mud novice who has a fascination for process. Cast porcelain shapes with a nod to childhood recollections are a staple for the trails and tribulations of glazing ideas. Her scrafitto explorations take her back to print and sketching styles. Carla will be undertaking porcelain casting demonstrations throughout the weekend.



### 3. Eddie McKay

021 506 726

eddie@bridgingthegap.co.nz

suzibrownglass.co.nz/page/597858

Eddie McKay started cutting glass in a secondary school workshop many years ago. As a student he created suncatchers, clock faces and chimes selling these at markets. Cutting glass and creating pieces of art has always been a calming creative outlet for him. After working the education sector for over 2 decades Eddie has taken account of what he needs to be happy. He is now a part time leadlighter, part time glass artist and he enjoys every moment. A suncatcher workshop will be held over the trail weekend.

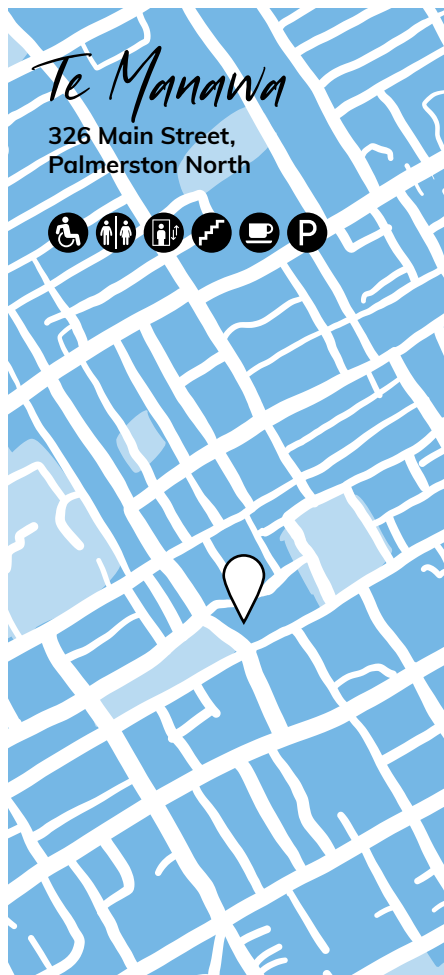

## Look.See.Think. Connect

Te Manawa Art Gallery  
326 Main Street

Sun 17 October:  
10am, 11.15am, 12.30pm

Limited places, bookings essential:  
[www.surveymonkey.com/r/TXWLHLJ](http://www.surveymonkey.com/r/TXWLHLJ)

Have you ever wondered what is stored in the vaults of our art gallery? Join members of the Manawātū Art Collection for a one-hour behind-the-scenes visit, involving 'four ways of looking at art'.



# Snails; Artist Run Space

103 Taonui Street, Palmerston North  
+64 22 492 8044

snailspalmy@gmail.com

f snailsartistrunspace



Snails: Artist Run Space houses several artists with backgrounds in different disciplines: painters, film makers, tattoo, textiles, collage, sound and beyond. 'Snails' is also an original music venue, a popular 'stop off' for the more adventurous bands and musicians in Aotearoa. Their top floor is split into Gallery space, delivering a different show each month, and a performance lounge for music and live acts.

Downstairs is Tiny Club, a collective of electronica-based musicians and artists. Snails is inclusive, vibrant, and bound by a need for community and expression.

Snails studio artists include: Sarah Bingle, Kirsty Porter, Chris Lambert, Deano Shirriffs, Pania Molloy, Jacks, and Tiny Club

Check out their Facebook page or call in over the weekend for sound and music performances.

## Kirsty Porter Shifting Ground

Kirsty is a painter, musician, educator, activist and Mother. She studied painting at RMIT (Melbourne) and UCOL (Whanganui) and maintains a painting practice out of a studio at Snails Artist Run Space.

This year she was lucky enough to receive a generous grant from the Earle Creativity Trust which allowed her the time to focus her work into a single body called *Shifting Ground*.

Though none of the works in *Shifting Ground* are for sale there will be small works on paper available at reasonable prices.



# SwampFest21

Creative Sounds Society is a non-profit organisation dedicated to the encouragement of creative musical, artistic, and performance activities. For over 30 years we've run an all-ages venue, recording studio and rehearsal spaces affectionately known as The Stomach in Palmerston North.

For over 15 years SwampFest has been Palmerston North's all-original music festival, showcasing some of the freshest original music created right here by local musicians. Each year Creative Sounds Society gathers up a diverse and genre defying line-up of local musicians and collaborates with all-ages and accessible venues. SwampFest features quality performances and production from our best musicians.

SwampFest21 Passes will be available via UnderTheRadar or at the shows. All shows are All-Ages accessible.

SwampFest21 is brought to you thanks to the support of Creative Sounds Society, The Stomach, Palmerston North City Council, Audio Progress Ltd, Radio Control 99.4FM and 409.

**Friday 15th & Saturday 16th October**  
**409 Church Street, Palmerston North**  
**7:30 - 9:30PM**

**Morphology:** A study of shape and form through music and visuals. Across two nights the inner ceilings and walls of 409 Church Street will flex with light and sound as large scale projection mapping images and graphics blend with a collection of musical envelope explorers from Te Papaioea. researchintospeed has curated a diverse and accessible music line-up with a separate sonic focus each night; Fri Oct 15th will feature guitar/bass/drums, while Sat 16th is all about the electronic, with hardware synths and modular set ups on show.



**Friday 22nd & Saturday 23rd October**  
**The Stomach**  
**84 Lombard Street, Palmerston North**  
**8:00 - 11:30PM**

**Live, loud and all-local:** A diverse line-up of our region's finest original musicians covering a range of genres over two nights. The Stomach is one of the best places in Aotearoa to see original music. Since its inception in 1988 The Stomach has been home to the weird and wonderful. The Stomach prides itself on being all-ages and accessible, ensuring that everyone, young and old, can experience the best live original music.



Photo credits: Katie Cheer and Fraser Williams.

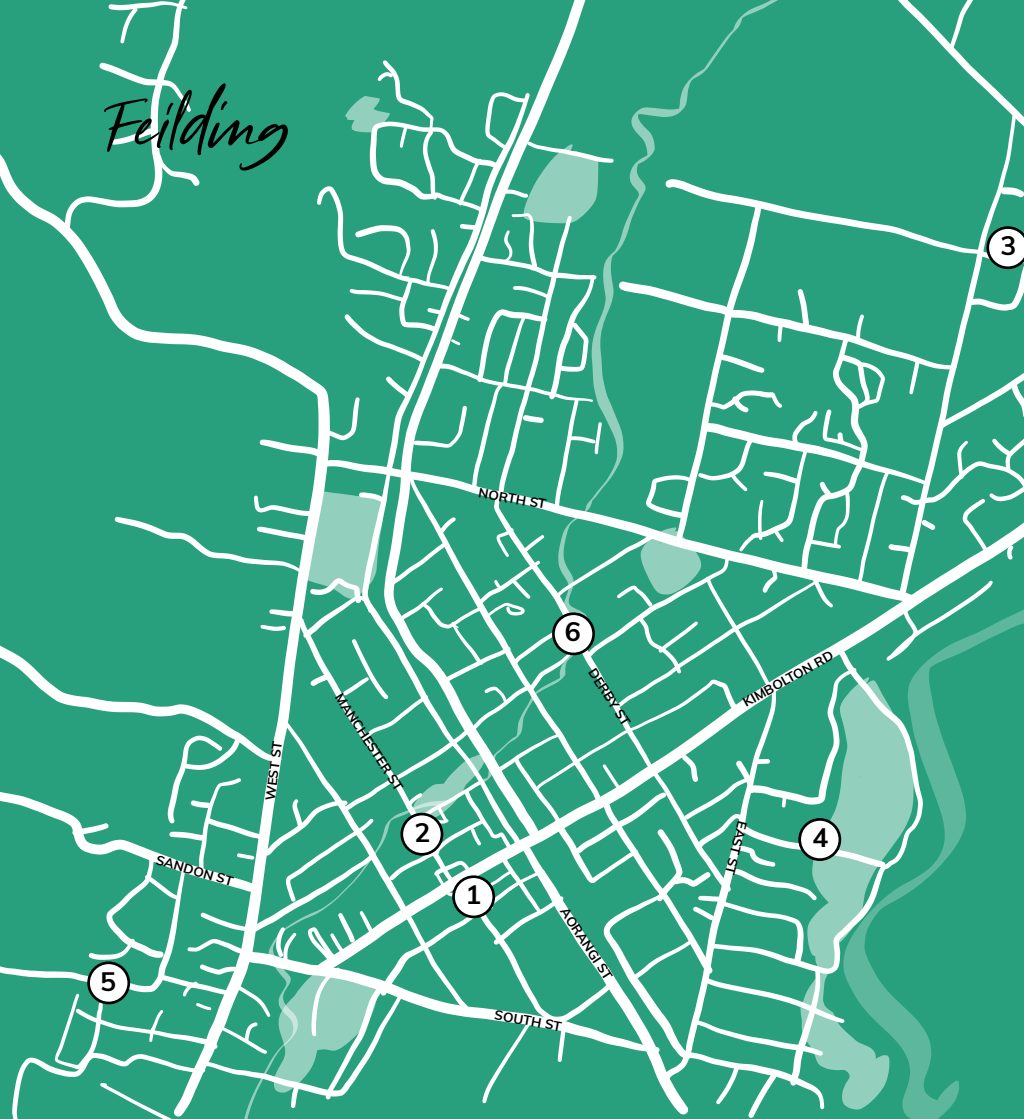

## 1. The Art Studio and Gallery - Joe McMenamin

51a Fergusson Street  
027 303 6974



mrjoemcmenamin@gmail.com  
www.joemcmenamin.com

Joe McMenamin is a painter and printmaker. The flowing organic patterns that ripple through his murals, acrylic painting and pen and ink works have won him a following throughout New Zealand. Joe has a Bachelor of Media Arts from the Waikato Institute of Technology. As a secondary School Art teacher for 14 years Joe got lots of ideas for his work through the interactions with his students. At the start of 2017 Joe finished teaching to become a full-time artist. In 2018 he opened the Art Studio and Gallery in Feilding, where he paints, teaches art classes and exhibits artworks.







## 2. Feilding and District Art Society

104 Manchester Street   
06 323 2323  
art@fadas.co.nz  
feildingartsociety.com

As an arts society FADAS showcase works of many local artists. They run workshops tutored by recognised artists, are responsible for the organisation and running of several regional events annually, and provide an environment for all artists working in any genre to exhibit their works. Works in painting (oils, acrylics, watercolours), ceramics, sculpture, woodturning, weaving, jewellery and mixed media (knitting, embroidery and drawing) are available.



## 3. Karen Sinclair

12 Cherry Place   
021 123 8261  
ktaylor.innz@gmail.com  
 karensinclairartworks

Self-taught multi-disciplinary artist Karen Sinclair has a love for colour, nature, and people, drawing inspiration from the world around her. She aims to arouse intense feelings of nostalgia and connect the viewer to a place or thing that is important to them, allowing her to be a part of their journey. Realism is her thing, using detail and dimension to represent subject matter truthfully and honestly. She has completed many commissions for clients both here and in the UK.



## 4. Sue James

24 Campbell Street   
027 610 2654  
suejames@suejamesdesign.co.nz  
www.jamesjamesdesign.co.nz  
 @jamesjamesdesign

You will find an eclectic mix of work in Sue James' studio, including works in oil, photography, charcoal drawing, laser and hand cut print works on paper and textiles. Sue is currently working on a series of charcoal portraits. Trained as a printmaker, though her first love is oil painting, she inspired by New Zealand's beautiful light and dramatic landscapes.



## 5. Walkers Woodturning - Mike and Helen Walker

15 Glasgow Terrace

021 034 3402

walkerswoodturning@hotmail.co.nz

walkerswoodturning.co.nz

Walkers woodturning is a family run woodwork business. Mike is a skilled craftsman, making wood turned items of all shapes and sizes. His passion for wood turning began with many childhood hours spent turning with his grandfather. Strongly influenced by both agriculture and nature he draws patterns from hill, rivers, imperfections in the wood, and the way the light catches objects. Helen enjoys making cold pressed soaps and balms which she sells at local markets and online.



## 6. Gay Janssen

70 Derby Street

021 064 4073

70antag@gmail.com



Using a pyrography machine Gay burns pictures into wood. This is achieved by electronically heating a wire tip which is used to create the desired depth and texture. Coloured pencils and water colour paints are used to enhance the finished work. Gay has previously created marionette puppets and wooden toys.



## Foibles and Mania Gallery

248 Halcombe Road, Feilding



## 1. Fiona Graham

021 303 382

Art@fionagraham.co.nz

www.fionagraham.co.nz

@ fionafibreartist

From her earliest memories Fiona can recall textures, colours, and a love of books. Today those elements allow her to express her thoughts through stitch and thread, dyes and beads, ink, and paper. Art study at Massey and with The Learning Connexion encouraged her to focus on fibre and mixed media art. Still, she sometimes spirals off into embellished printmaking and bookbinding.



## 2. Sam Lewry

021 022 66771

sam@lewry.co.nz

www.lewry.co.nz

 SamLewryNZArtist  sam.lewry

Working with primarily with oils, Sam's creative work generally starts by looking past the human activity covering everything, until she finds a piece of nature that draws her in. The subject could be as small as a feather, or the connecting shapes of hills, sea or sky. Imagined environments and stylised landscapes usually unfold as Sam gets lost in the colour and curves of a work. Sam is thrilled to be exhibiting again at Foibles and Mania Gallery, Feilding with Fiona Graham and Belinda Howard.



## 3. Belinda Howard

027 357 6668

belindah@inspire.net.nz

@ the\_gardeners\_cottage\_art

While Belinda Howard loved art school she was unable to carry on with it. Looking back she believes that this was probably a good thing as she has come to art as a mature woman with a stronger sense of self. Belinda has been a student at the Learning Connexion over three years and has completed a Level 4 certificate and a Level 5 diploma in art and creativity. These programmes have encouraged her to play and find her own unique path. Belinda works in a wide range of media, including paint print and clay.



# Ashhurst and Pohangina Valley



## 1. Graham Christensen

84 Glenburn Road  
Ashhurst (off Napier Road)

021 238 6784

[paintergnc@gmail.com](mailto:paintergnc@gmail.com)

[www.grahamchristensen.co.nz](http://www.grahamchristensen.co.nz)

[f](#) GrahamChristensen.NZartist

[@](#) graham.christensen.nz.artist



Graham Christensen did not pick up an artist's brush until his early 60s, but he quickly showed a natural talent with oils and a great affinity with the rural landscape. He lives on a farm near Ashhurst and works from a large light filled studio. Graham's oil and acrylic paintings depict his lifelong love of farming and the rugged landscape that New Zealand offers. His latest works are a reminiscence of rural life and moments in time that make up the rich tapestry of farming communities.



## 2. County Fayre - Jill Walcroft

976 Finnis Rd, Pohangina

022 165 6657

jill@jadefarm.co.nz

f jill.walcroft



The gallery at County Fayre supports local artists from the Pohangina Valley and near-by. The gallery has a vision of bringing people together. Jill and other artists share a variety of work, with Jill creating mainly 2-dimensional works on canvas, board, and paper, using gouache and ink or acrylic paint, and woven paper. Artists will be working in a wide range of media: Jill O'Brien pastel on paper paintings; Jill Walcroft gouache on paper paintings and woven photography; Francee Navest – will have some paintings at County Fayre (this is a secondary site) as well as at her primary site at her own studio; and Awahou Primary School children –small canvas paintings.



## 3. Francee Navest Navest Art Studio

476 Finnis Road RD5

021 255 5222

kiwicolours@yahoo.co.nz

f Francee Navest



Francee Navest has a small art studio space called NAVEST ART STUDIO. This is a place where she can create and play. Francee believes that she is on a journey of self-discovery and is passionate about telling that story through her art. Francee feels she is very blessed to share her studio with you.

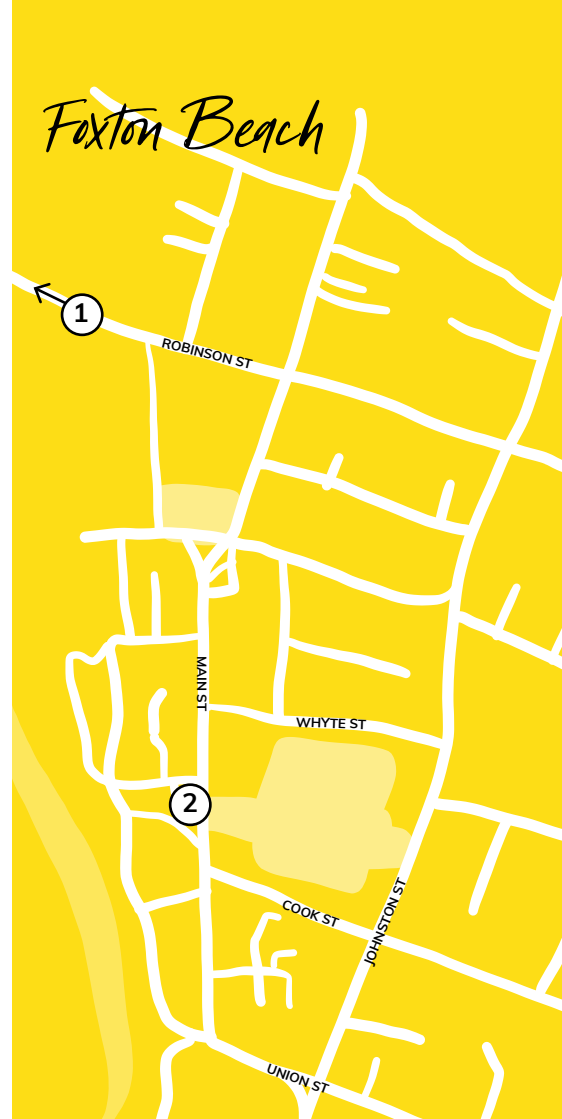



## 1. Mel Fleet

24 Dewe Terrace,  
Foxton Beach  
021 258 9547  
fleetingfancy@gmail.com  
fleetingfancy.co.nz  
f @ fleetingfancy

A multi-disciplinary artist, Mel enjoys the diversity of creating in many formats, yet photography is her first love. Working mainly in still life and landscape, Foxton Beach offers her inspiration. She paints with acrylic on canvas but also works on found objects, creates jersey coats and garden art from recycled and reclaimed materials.



## 2. Te Awahou Nieuwe Stroom Artitude - with Colour and Coffee

92 Main Street Foxton  
027 283 3564  
peter.jillhammond@gmail.com

Open Friday 15th to Tuesday 18th  
October

Sue Taylor, Len Cullinane, Zane Goode, Joan Tinsley, Jude Batten and Jill Hammond make up a group who call themselves Artitude – with Colour and Coffee. Drawn from Foxton and Foxton Beach the artists meet regularly at Te Awahou Nieuwe Stroom to paint and share ideas. Their works utilise a wide range of media including watercolour, acrylics, oils, pastels and inks and the subjects they address range from flowers, animals, land and seascapes to large works in a pop art style. Artists will be working on site at this hub for an extended period.



## 'Pop Art' Auction

A brightly coloured 'pop art' painting by Zane Goode, bringing together Foxton's funkiest landmarks, will be sold by Auction on the Sunday.

Zane is a member of the Artitude local arts group, with its works on display, and will be present at the fun event.

Keen bidders will congregate at the Te Awahou Nieuwe Stroom cultural hub.

**Sunday 17 October: 92 Main Street, Foxton.**

The café, museums and art gallery will be open. Join the banter and 'art critiques'.

**Auction: from 1pm onwards, in the Open Space.**



# Maximising your art trail experience

## Tip 1

**Get together a group and share the driving.** Connect with friends while enjoying a special day out.

## Tip 2

**Book out the weekend** or work out how much time you have available.

## Tip 3

**Plan your routes.** Which artists and studios are you most keen to visit? How much time will your route take? Where will you want to stop for lunch?

## Tip 4

**Break the trail information into two parts** and do it over two days, so you have time to wander in a relaxed way (for example, do Foxton to Palmerston North one day and Feilding and districts to Pohangina the next).

## Tip 5

**Allow time** – at least 20-30 minutes per studio and a couple of hours for each hub space and travel time in between.

## Tip 6

**Expect to find more gorgeous things than you have cash for!** Some spaces will have EFTPOS but many will only accept Internet banking or cash. You may wish to withdraw cash in town to take your you.

## Tip 7

**Think about where you will stop for refreshments.** Square Edge has a cafe, and there will be coffee and a food truck on site at Caccia Birch. There are also cafes in Palmerston North, Feilding, Ashhurst and Te Awahou Nieuwe Stroom in Foxton.

### Tip 8

#### **Bring along your questions.**

Our artists love sharing their process and thinking with visitors, so please don't be afraid to ask!

### Tip 9

If you have a specific work in mind, then **chat to our artists** about a commission piece.

### Tip 10

**Take artists' contact information away with you,** or keep this trail guide book somewhere safe, so you can message the artists whose works you love when you need a gift down the track.

### Tip 11

**Share your experience** on social media to help us promote this free event.

### Tip 12

**Collect a coloured dot from each region you visit.** This allows you to enter the prize draw!

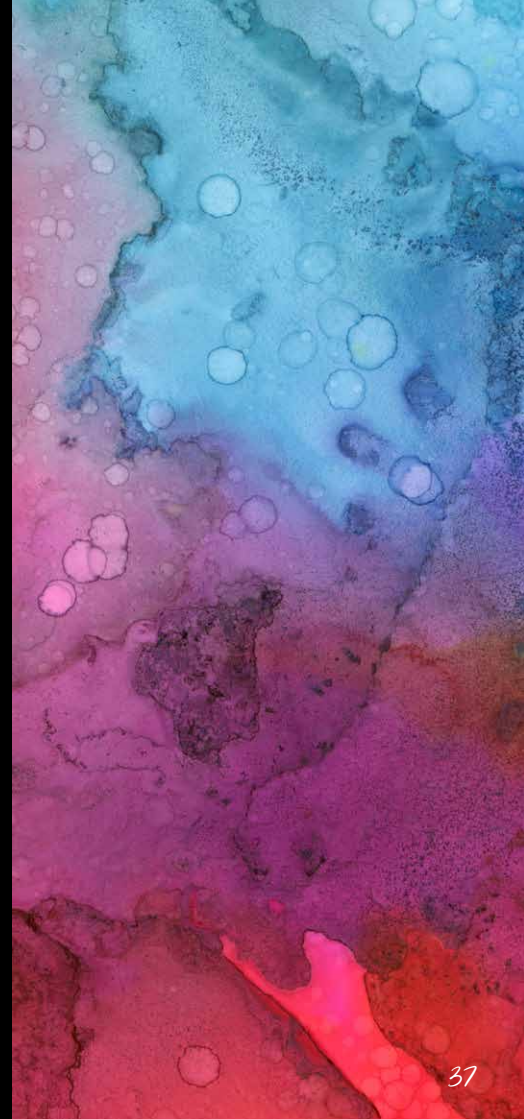



*Visit our website for more information*

[WWW.COMMUNITYARTS.ORG.NZ](http://WWW.COMMUNITYARTS.ORG.NZ)

*Collect the dots for your chance to win!*

YOUR NAME:

CONTACT PHONE NUMBER:

EMAIL ADDRESS:

☐

(Tick) Please add us as Square Edge members - its free!

Receive our monthly newsletter with updates about exhibitions, workshops, and events.

FEEDBACK ABOUT THE 2021 TRAIL:

Leave your completed entry forms in the drop box at Square Edge Arts Centre, or scan and email them to us to add to the draw: [reception@ca.org.nz](mailto:reception@ca.org.nz)

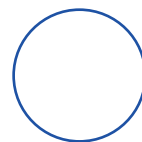

**Square Edge**

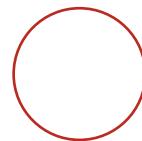

**Caccia Birch**

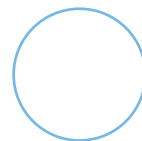

**Palmerston North**

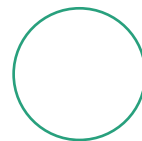

**Feilding**

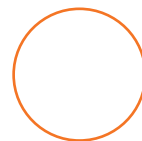

**Ashhurst and  
Pohangina**

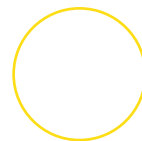

**Foxton and  
Himatangi**



2021

fisherprint